

ROHS G103

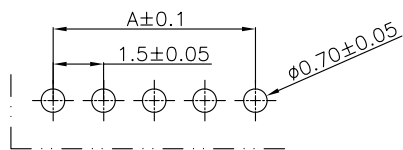
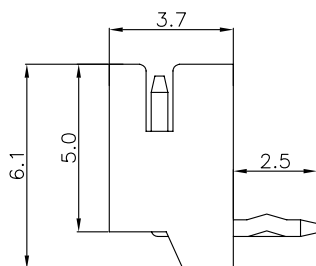
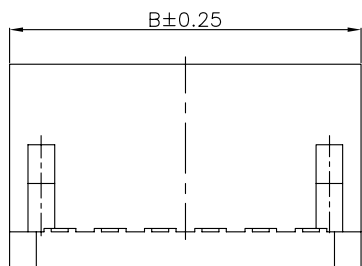
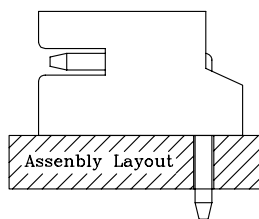
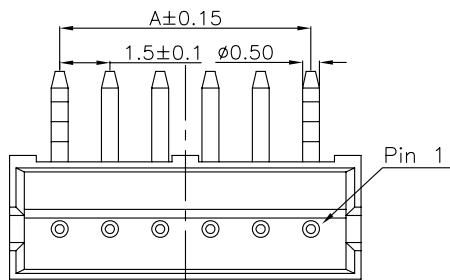

RECOMMENDED PCB LAYOUT
(TOLERANCE:±0.10)

1.ELECTRICAL SPECIFICATIONS:

- 1.1 Rated current and voltage(额定电流):
1.0A 50V AC(r.m.s)
- 1.2 Dielectric Withstanding Voltage(耐电压) :
500V AC for one minute
- 1.3 Contact Resistance(接触电阻) :
20mΩ max
- 1.4 Insulation Resistance(绝缘电阻) :
500MΩ min
- 1.5 Operating Temperature(工作温度) :
-25℃ ~ 85℃

2.MATERIAL SPECIFICATION:

- 2.1 Insulator Material(绝缘体材质):
High Temperature Plastic,UL94V-0(nature)
- 2.2 Contact Material(端子材质):
Brass
- 2.3 Applicable wire:32AWG TO 26AWG

▲ Non-tooled parts
No.of positions DIM list:

CONTACTS	DIMENSIONS	
	A	B
2	1.50	4.50
3	3.00	6.00
4	4.50	7.50
5	6.00	9.00
6	7.50	10.50
7	9.00	12.00
8	10.50	13.50
9	12.00	15.00
10	13.50	16.50
11	15.00	18.00
12	16.50	19.50
▲ 13	18.00	21.00
▲ 14	19.50	22.50
▲ 15	21.00	24.00
▲ 16	22.50	25.50

PART NO. LEGEND:
WB1521DR-XXT3

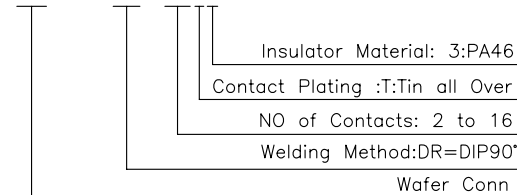

DRAWING:
Hu yatao

GENERAL TOLERANCE

.X:=±0.30 .X':=±2°
.XX:=±0.20 .XX':=±1°
.XXX:=±0.10 .XXX':=±0.5°

CHECKED:
Tony

UNIT: MM

PROJECTION:

APPROVAL:
Yang jie

SCALE: N/A

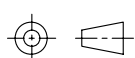

SHEET: 1/1



CHIN-BAN
electronics (H.K.) co., ltd

DESCRIPTION:

1.5mm Pitch Side Entry Type

PART NO: WB1521DR-XXT3

REV: 1.0

CUSTOMER NO:

SIZE: A4

E				DRAWING: Hu yatao	GENERAL TOLERANCE .X:=±0.30 .X':=±2° .XX:=±0.20 .XX':=±1° .XXX:=±0.10 .XXX':=±0.5°	<p>CHIN-BAN electronics (H.K.) co., ltd</p>
D				CHECKED: Tony	UNIT: MM PROJECTION:	
C				APPROVAL: Yang jie	SCALE: N/A	DESCRIPTION: 1.5mm Pitch Side Entry Type
B					SHEET: 1/1	PART NO: WB1521DR-XXT3 REV: 1.0
A						CUSTOMER NO: SIZE: A4
NO.	DATE	DESCRIPTION	APPROVAL			

ROHS G103

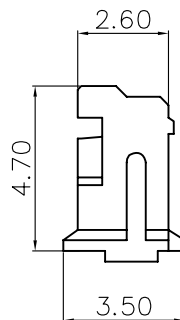
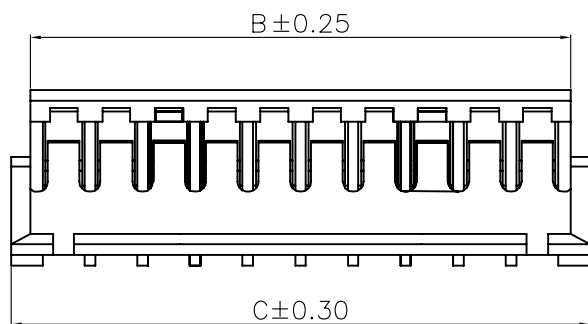
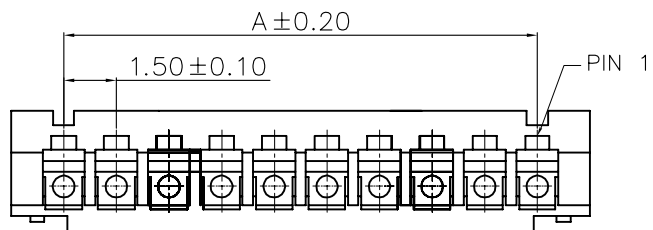

1.ELECTRICAL SPECIFICATIONS:

- 1.1 Rated current and voltage(额定电流):
1.0A 50V AC(r.m.s)
- 1.2 Dielectric Withstanding Voltage(耐电压) :
500V AC for one minute
- 1.3 Contact Resistance(接触电阻) :
20mΩ max
- 1.4 Insulation Resistance(绝缘电阻) :
500MΩ min
- 1.5 Operating Temperature(工作温度) :
-25°C ~ 85°C

2.MATERIAL SPECIFICATION:

- 2.1 Insulator Material(绝缘体材质):
PA66,UL94V-0(nature)
- 2.2 Applicable wire:32AWG TO 26AWG

▲ Non-tooled parts
No.of positions DIM list:

CONTACTS	DIMENSIONS		
	A	B	C
2	1.50	3.40	4.50
3	3.00	4.90	6.00
4	4.50	6.40	7.50
5	6.00	7.90	9.00
6	7.50	9.40	10.50
7	9.00	10.90	12.00
8	10.50	12.40	13.50
9	12.00	13.90	15.00
10	13.50	15.40	16.50
11	15.00	16.90	18.00
12	16.50	18.40	19.50
▲ 13	18.00	19.90	21.00
▲ 14	19.50	21.40	22.50
▲ 15	21.00	22.90	24.00
▲ 16	22.50	24.40	25.50

PART NO. LEGEND:
WB1501USH-XXP2

Insulator Material: 2:PA66
NO of Contacts: 2 to 16
H:Housing
Wafer Conn

DRAWING:
Hu yatao

GENERAL TOLERANCE

.X:=±0.30 .X':=±2°
.XX:=±0.20 .XX':=±1°
.XXX:=±0.10 .XXX':=±0.5°

CHECKED:
Tony

UNIT: MM

PROJECTION:

DESCRIPTION:

CHIN-BAN
electronics (H.K.) co., ltd

1.50mm PITCH HOUSING

APPROVAL:
Yang jie

SCALE: N/A

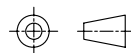

PART NO: WB1501USH-XXP2

REV: 1.0

NO. DATE DESCRIPTION APPROVAL

SHEET: 1/1

CUSTOMER NO:

SIZE: A4

ROHS G103

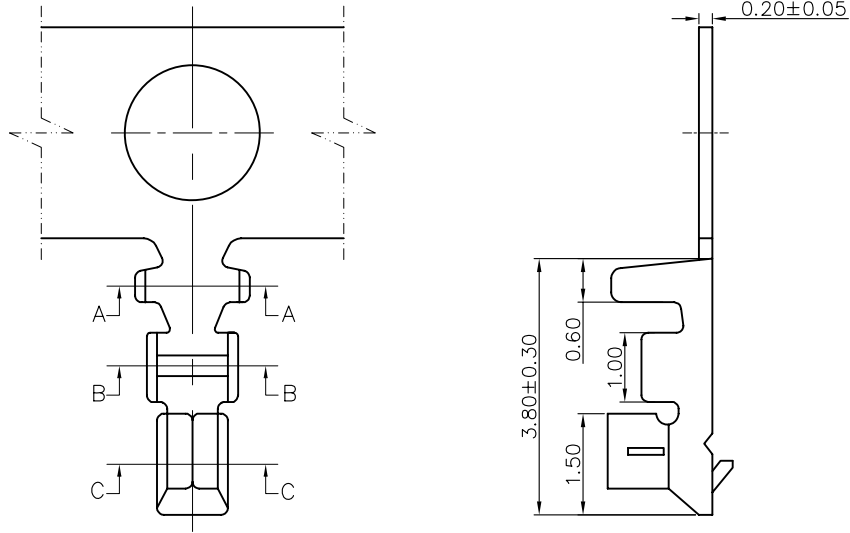

1.ELECTRICAL SPECIFICATIONS:

- 1.1 Rated current and voltage(额定电流):
1.0A 50V AC(r.m.s)
- 1.2 Dielectric Withstanding Voltage(耐电压) :
500V AC for one minute
- 1.3 Contact Resistance(接触电阻) :
20mΩ max
- 1.4 Insulation Resistance(绝缘电阻) :
500MΩ min
- 1.5 Operating Temperature(工作温度) :
-25°C ~ 85°C
- 1.6 Material:
Phosphor Bronze (UL94V-0); Tin
- 1.7 Applicable wire:32AWG TO 26AWG

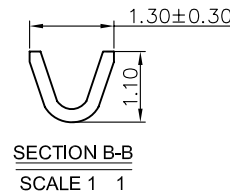
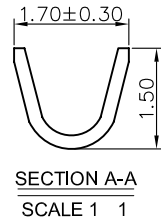
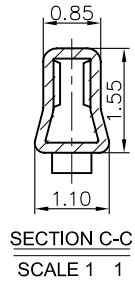

PART NO. LEGEND:
WB1501UST-T2

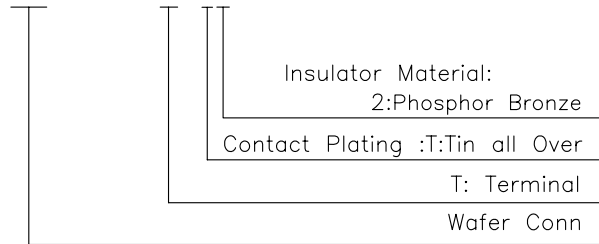

DRAWING:
Hu yatao

GENERAL TOLERANCE

.X: =±0.30 .X': =±2°
.XX: =±0.20 .XX': =±1°
.XXX: =±0.10 .XXX': =±0.5°

CHECKED:
Tony

UNIT: MM

PROJECTION:

APPROVAL:
Yang jie

SCALE: N/A

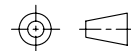

SHEET: 1/1



CHIN-BAN
electronics (H.K.) co., ltd

DESCRIPTION:

1.50mm Pitch Terminal

PART NO: WB1501UST-T2

REV: 1.0

CUSTOMER NO:

SIZE: A4

E			
D			
C			
B			
A			
NO.	DATE	DESCRIPTION	APPROVAL