

ROHS

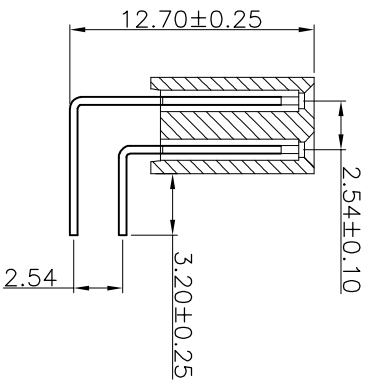

1. ELECTRICAL SPECIFICATIONS:

- 1.1 Rated current and voltage(额定电流):
3A 250V AC(r.m.s)
 - 1.2 Dielectric Withstanding Voltage(耐电压) :
600V AC for one minute
 - 1.3 Contact Resistance(接触电阻) :
<20mΩ
 - 1.4 Insulation Resistance(绝缘电阻) :
>1000MΩ
 - 1.5 Operating Temperature(工作温度) :
-40℃ ~ 105℃
2. MATERIAL SPECIFICATION:
- 2.1 Insulator Material(绝缘体材质):
High Temperature Plastic ,
UL94V-0
 - 2.2 Contact Material(端子材质):
Brass

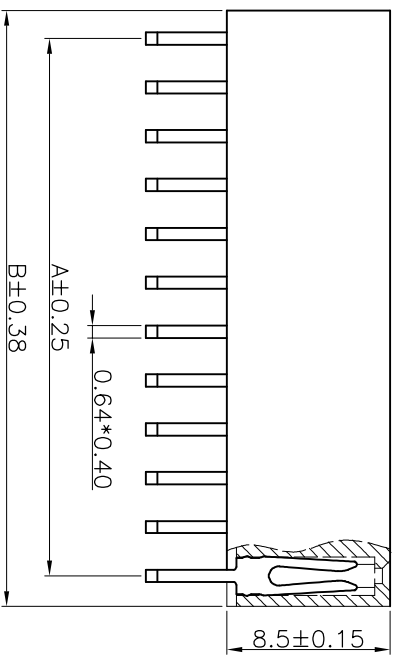
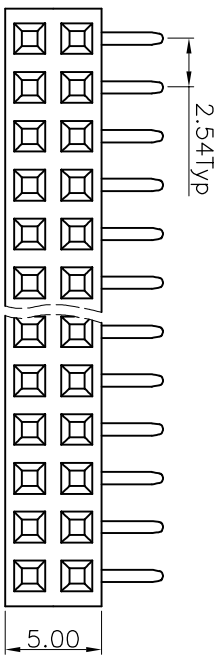
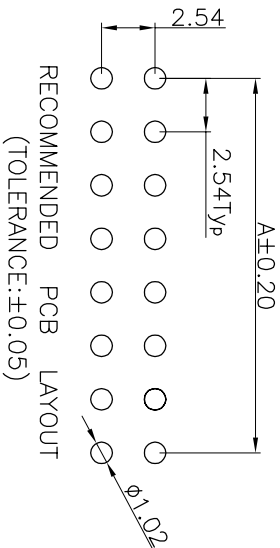

PART NO. LEGEND:
FP 6 Q XX J -B 1 Y 32-X

Female Header
Pitch:6=2.54mm
Plastic Height: Q=8.50mm
NO of Contacts: 4 to 80

Packing: B:TRAY
C:TUBE
Contact Plating : 1:G/F
Insulator Material: B:PA6T
Series No: J

▲Non-tooled parts
NO.of positions DIM list:

CONTACTS	DIMENSIONS	
	A	B
4	2.54	5.48
6	5.08	8.02
8	7.62	10.56
10	10.16	13.10
12	12.70	15.64
14	15.24	18.18
16	17.78	20.72
18	20.32	23.26
20	22.86	25.80
22	25.40	28.34
24	27.94	30.88
26	30.48	33.42
28	33.02	35.96
30	35.56	38.50
32	38.10	41.04
34	40.64	43.58
36	43.18	46.12
38	45.72	48.66
40	48.26	51.20
42	50.80	53.74
44	53.34	56.28
46	55.88	58.82
48	58.42	61.36
50	60.96	63.90
52	63.50	66.44
54	66.04	68.98
56	68.58	71.52
58	71.12	74.06
60	73.66	76.60
62	76.20	79.14
64	78.74	81.68
66	81.28	84.22
68	83.82	86.76
70	86.36	89.30
72	88.90	91.84
74	91.44	94.38
76	93.98	96.92
78	96.52	99.46
80	99.06	102.00



CHIN-BAN
electronics (H.K.) co., ltd

DESCRIPTION:

2.54mm Pitch Female Header Double Row DIP90°

PART NO: FP6QXXJ-B1Y32-X

CUSTOMER NO:

REV:1.0
SIZE: A4

DRAWING:

Hu yatao

CHECKED:

Tony

APPROVAL:

Yang jie

GENERAL TOLERANCE

X: ±0.30
.XX: ±0.20
.XXX: ±0.10

X*: ±2°
.XX*: ±1°
.XXX*: ±0.5°

UNIT: MM

PROJECTION:

SCALE: N/A

SHEET: 1/1

DRAWING:

Hu yatao

CHECKED:

Tony

APPROVAL:

Yang jie

GENERAL TOLERANCE

X: ±0.30
.XX: ±0.20
.XXX: ±0.10

X*: ±2°
.XX*: ±1°
.XXX*: ±0.5°

UNIT: MM

PROJECTION:

SCALE: N/A

SHEET: 1/1

DESCRIPTION:

2.54mm Pitch Female Header Double Row DIP90°

PART NO: FP6QXXJ-B1Y32-X

CUSTOMER NO:

REV:1.0
SIZE: A4