

ROHS G079

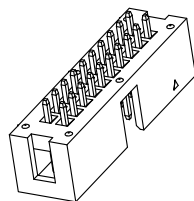
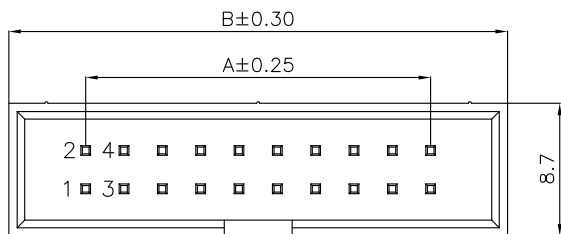

1, ELECTRICAL SPECIFICATIONS:

- 1.1 Rated current (额定电流): 3A
- 1.2 Dielectric Withstanding Voltage(耐电压): 1000V AC for one minute
- 1.3 Contact Resistance(接触电阻): <20mΩ
- 1.4 Insulation Resistance(绝缘电阻): >1000MΩ
- 1.5 Operating Temperature(工作温度): -40°C ~ 105°C

2, MATERIAL SPECIFICATION:

- 2.1 Insulator Material(绝缘体材质): PBT/PA6T
- 2.2 Contact Material(端子材质): Brass

▲ Non-tooled parts
NO. of positions DIM list:

CONTACTS	DIMENSIONS	
	A	B
10	10.16	20.4
12	12.70	22.94
14	15.24	25.48
16	17.78	28.02
18	20.32	30.56
20	22.86	33.10
22	25.40	35.64
24	27.94	38.18
26	30.48	40.72
28	33.02	43.26
30	35.56	45.80
32	38.10	48.34
34	40.64	50.88
36	43.18	53.42
38	45.72	55.96
40	48.26	58.50
42	50.80	61.04
44	53.34	63.58
46	55.88	66.12
48	58.42	68.66
50	60.96	71.20
52	63.50	73.74
54	66.04	76.28
56	66.58	78.82
58	71.12	81.36
60	73.66	83.90
62	76.20	86.44
64	78.74	88.98

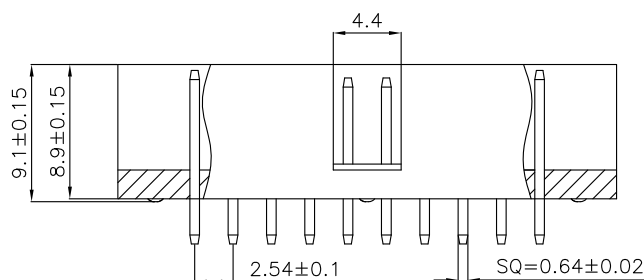
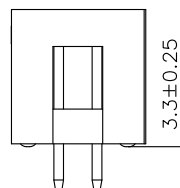

PART NO	SPECIFICATIONS DESCRIBE
B05A20E-B133-B	2*10 PA6T G/F

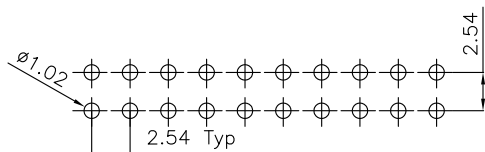

RECOMMENDED PCB LAYOUT
(TOLERANCE:±0.10)

PART NO. LEGEND:

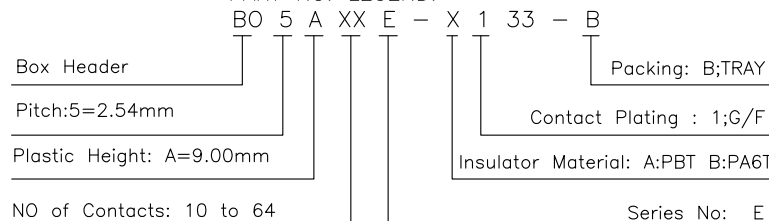

E				DRAWING:	GENERAL TOLERANCE .X:=±0.20 .X':=±2° .XX:=±0.15 .XX':=±1° .XXX:=±0.10 .XXX':=±0.5°
D				Hu yatao	
C				CHECKED:	
B	2020.6.15	Update the drawing	Yang jie	Tony	UNIT: MM PROJECTION:
A	2017.8.22	NEW	Yang jie	APPROVAL:	SCALE: N/A
NO.	DATE	DESCRIPTION	APPROVAL	Yang jie	SHEET: 1/1



CHIN-BAN
electronics (H.K.) co., ltd

DESCRIPTION:
2.54mm Pitch Box Header Double Row DIP180°

PART NO:	B05AXXE-X133-B	REV:2.0
CUSTOMER NO:		SIZE: A4